

An Eco-Landbridge at Union Corners

*A Proposal to Link Neighborhoods Across East Washington Avenue
From CRANES Inc*



Developer proposed 3-5 story building
(library, mixed use, residential)

Developer proposed 3-5 story anchor building
(health science, research, offices)

- 1 Public plaza, dining area, view of Capitol Dome.
- 2 2-Story residential or other mixed use building w/ view of Capitol Dome & greenroof.
- 3 Stormwater infiltration, cisterns, and neighborhood greenspace; potential for parking under bridge structure.
- 4 Sheltered / heated Bus Rapid Transit (BRT) stop.
- 5 Daylighting / skylight for BRT stop.
- 6 2-Story commercial, office, or other mixed use facilities; opportunity for greenroof & PV solar panels.
- 7 1-Story commercial, office, or other mixed use facilities.
- 8 Stormwater infiltration, cisterns, and neighborhood or church-managed greenspace.
- 9 2-Story public / private anchor building, entrances at both levels.

ECO-LANDBRIDGE LINK
Bird's Eye View
Facing south from above North St

- 1** Public plaza, dining area, view of Capitol Dome.
- 2** 2-Story residential or other mixed use building w/ view of Capitol Dome & greenroof.
- 3** Stormwater infiltration, cisterns, and neighborhood greenspace; potential for parking under bridge structure.
- 4** Sheltered / heated Bus Rapid Transit (BRT) stop.
- 5** Daylighting / skylight for BRT stop.
- 6** 2-Story commercial, office, or other mixed use facilities; opportunity for greenroof & PV solar panels.
- 7** 1-Story commercial, office, or other mixed use facilities.
- 8** Stormwater infiltration, cisterns, and neighborhood greenspace.
- 9** 2-Story public / private anchor building, entrances at both levels.

A ADA Ramp access to plaza level.

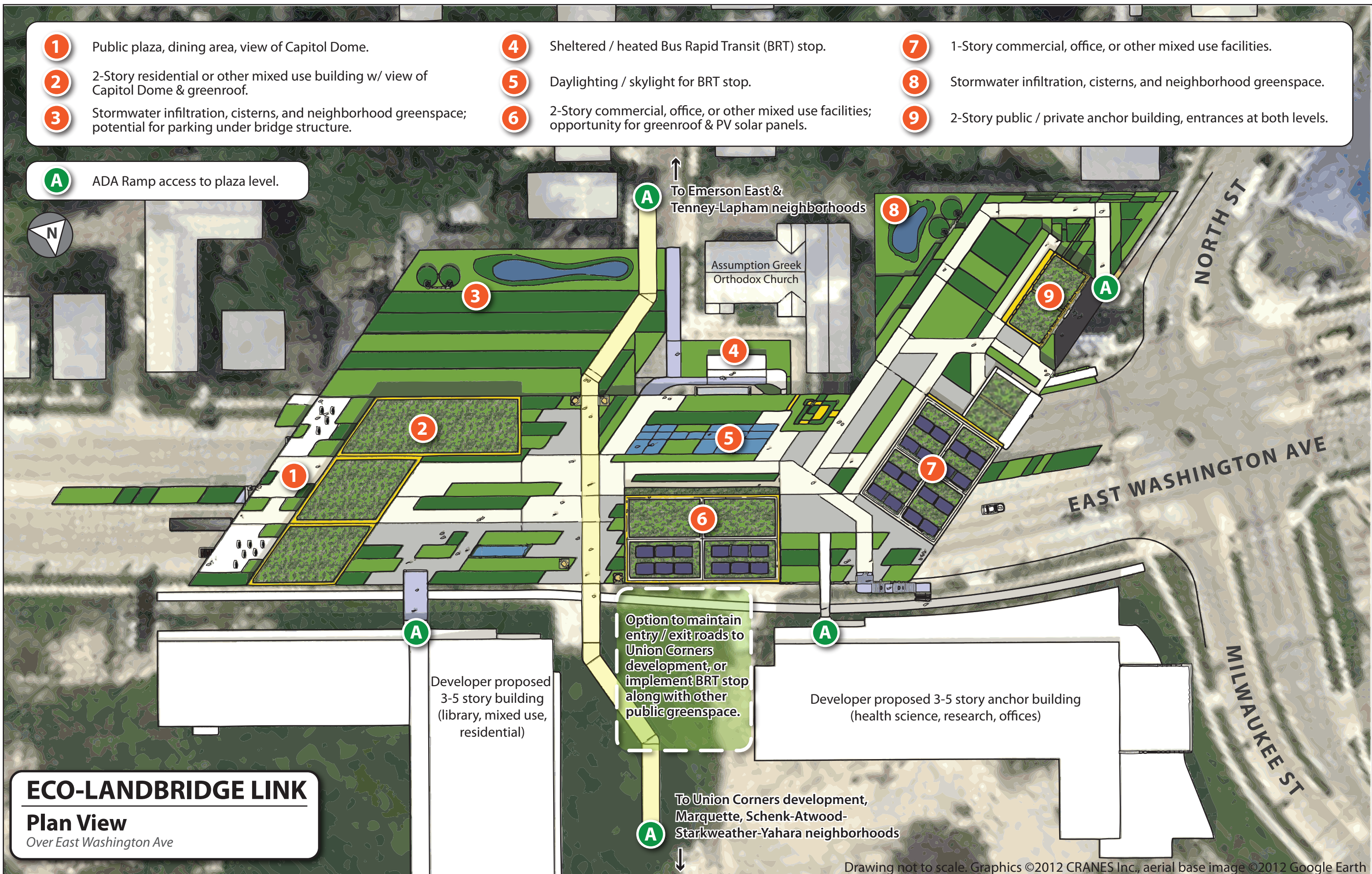

ECO-LANDBRIDGE LINK
Plan View
Over East Washington Ave

Drawing not to scale. Graphics ©2012 CRANES Inc., aerial base image ©2012 Google Earth



ECO-LANDBRIDGE LINK

Pedestrian Experience / Capitol View

Facing southwest along central plaza area.

We declare that the proper use of science is not to conquer nature, but to live in it.
- Gaylord Nelson, 1970



EAST WASHINGTON AVE

ECO-LANDBRIDGE LINK

East Corner Approach

Facing west from the corner of East Washington & Milwaukee St



Space below ADA Ramp area to be used for stormwater retention, parking, utilities, etc.

ECO-LANDBRIDGE LINK

2-Story Anchor Building

Facing south from above North St

NORTH ST



BRT heated shelter



Daylighting of roadway near BRT stop

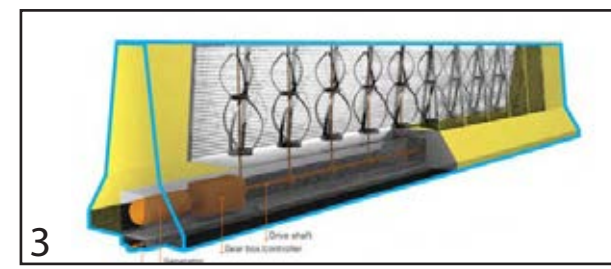

Vehicular-based wind power harvesting

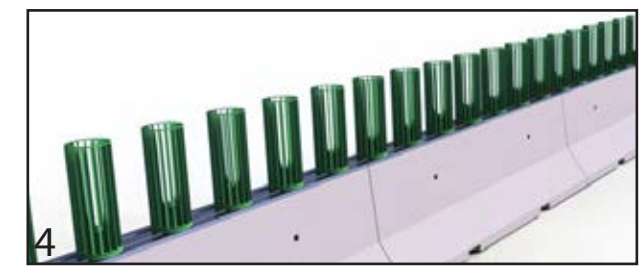

Graphics ©2012 CRANES Inc., aerial base image ©2012 Google Earth

ECO-LANDBRIDGE LINK
BRT Stop & Vehicular Wind Harvesting
Looking northeast along East Washington Ave

Image Credits:
1: <http://media.photobucket.com/image/recent/acieszyn/NBA%2520tour/Minnesota/Picture1318.jpg>
2: http://www.iluminacion-natural.com/eng_projects.htm
3: <http://www.treehugger.com/clean-technology/the-jersey-barrier-redesigned.html>
4: <http://www.earthtechling.com/2011/02/wind-turbine-concept-harvests-energy-roadside/>

Utilize topography of the existing hill on Dunning St

Provide safe transit across railroad corridor, accommodate future light rail station

Integrate existing Union Corners commuter path, along with bike lanes proposed on Winnebago St.

DUNNING ST

RAILROAD TRACKS

WINNEBAGO ST

ECO-LANDBRIDGE LINK
Railroad Pedestrian / Bicycle Crossing
Facing southwest towards Dunning St.

